

**LOCATION MAP SCALE 1:1000**

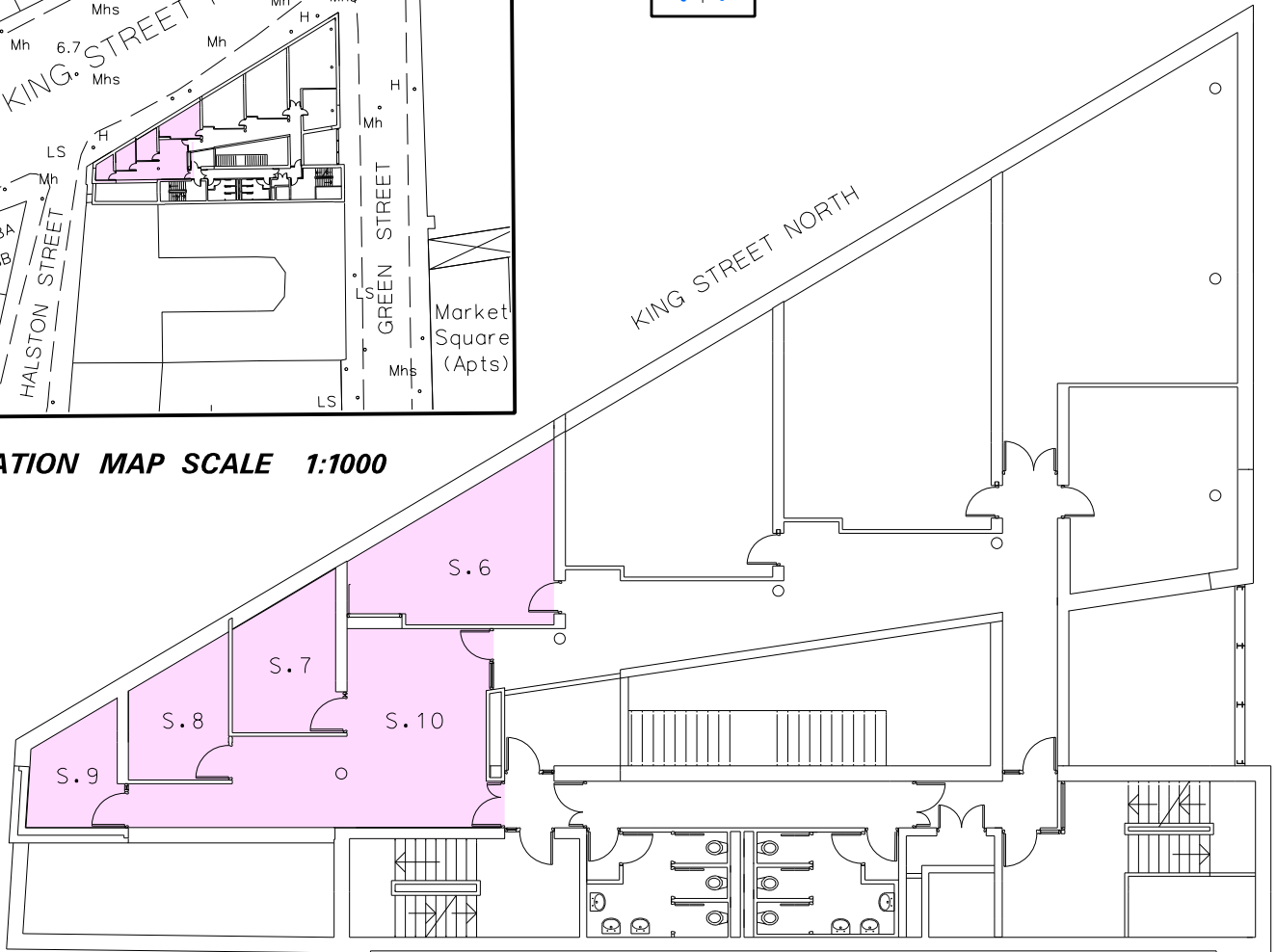

**SECOND FLOOR PLAN (SCALE 1:200)**

**HALSTON STREET /NORTH KING STREET /GREEN STREET - MACRO BUILDING**  
**Rooms S6, S.7, S.8, S.9, S.10 (AREA: 79.06 sq m)**  
**Dublin City Council to Snug Counselling Service**  
**GRANT OF LICENCE**



## DUBLIN CITY COUNCIL

*Comhairle Cathrach Bhaile Átha Cliath*  
**ENVIRONMENT AND ENGINEERING DEPARTMENT**  
*An Roinn Comhshaoil agus Innealtóireachta*  
**SURVEY AND MAPPING SERVICES DIVISION**  
*Rannán Seirbhísi Suirbhéireachta agus Léarscailithe*

<b>O.S REF</b> 3263-04, 3263-05	<b>SCALE</b> 1:1000 / 1:200
<b>DATE</b> 12.02.2014	<b>SURVEYED/ PRODUCED BY</b> FC

<b>INDEX No</b>	<b>FOLDER No</b>	<b>CODE</b>	<b>DWG No</b>	<b>REV</b>
<b>FILE NO</b>	SM-2010-0367-0204- C3 - 006 - A.dgn			

**FOR PROPERTY REGISTRATION AUTHORITY PURPOSES ONLY**  
 THIS MAP IS CERTIFIED TO BE COMPUTER GENERATED BY  
 DUBLIN CITY COUNCIL FROM ORDNANCE SURVEY DIGITAL MAPBASE

SIGNED \_\_\_\_\_  
 THOMAS CURRAN  
 ACTING MANAGER LAND SURVEYING & MAPPING  
 DUBLIN CITY COUNCIL

**INDEX No.**  
  
**SM-2010-0367-006**

**MICHAEL PHILLIPS**  
**CITY ENGINEER**